

Country Oaks

Map 2

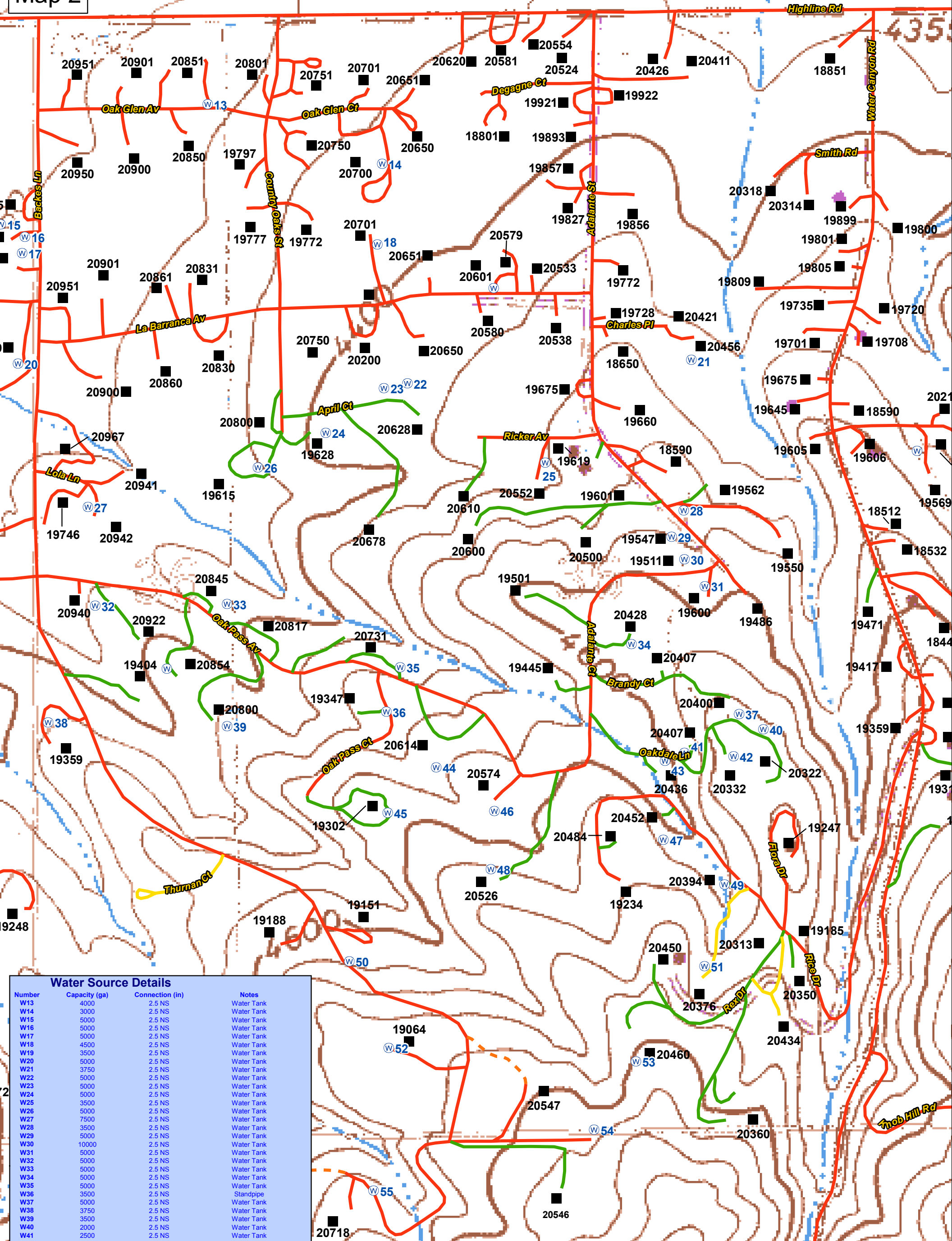

Number	Capacity (ga)	Connection (in)	Notes
W13	4000	2.5 NS	Water Tank
W14	3000	2.5 NS	Water Tank
W15	5000	2.5 NS	Water Tank
W16	5000	2.5 NS	Water Tank
W17	5000	2.5 NS	Water Tank
W18	4500	2.5 NS	Water Tank
W19	3500	2.5 NS	Water Tank
W20	5000	2.5 NS	Water Tank
W21	3750	2.5 NS	Water Tank
W22	5000	2.5 NS	Water Tank
W23	5000	2.5 NS	Water Tank
W24	5000	2.5 NS	Water Tank
W25	3500	2.5 NS	Water Tank
W26	5000	2.5 NS	Water Tank
W27	7500	2.5 NS	Water Tank
W28	3500	2.5 NS	Water Tank
W29	5000	2.5 NS	Water Tank
W30	10000	2.5 NS	Water Tank
W31	5000	2.5 NS	Water Tank
W32	5000	2.5 NS	Water Tank
W33	5000	2.5 NS	Water Tank
W34	5000	2.5 NS	Water Tank
W35	5000	2.5 NS	Water Tank
W36	3500	2.5 NS	Water Tank
W37	5000	2.5 NS	Water Tank
W38	3750	2.5 NS	Water Tank
W39	3500	2.5 NS	Water Tank
W40	2000	2.5 NS	Water Tank
W41	2500	2.5 NS	Water Tank
W42	3500	2.5 NS	Water Tank
W43	5000	2.5 NS	Water Tank
W44	5000	2.5 NS	Water Tank
W45	5000	2.5 NS	Water Tank
W46	5000	2.5 NS	Water Tank
W47	3000	2.5 NS	Water Tank
W48	3000	2.5 NS	Water Tank
W49	3000	2.5 NS	Water Tank
W50	5000	2.5 NS	Water Tank
W51	3000	1.5 NS	Water Tank
W52	3500	2.5 NS	Water Tank
W53	3750	2.5 NS	Water Tank
W54	3000	2.5 NS	Water Tank
W55	3500	2.5 NS	Water Tank

pumphouse w/ 200ft hose & conn @ tank
 Tank, might need to dig out connection

Engine Type	Symbol
Any Type	Structure
Type 3 or Smaller	Water Source
Type 4	
Impassible	

SPECIAL NOTES
 NO RECENT FUEL TREATMENTS
 NO IDENTIFIED SAFETY ZONES

